



Power Film 55DC Link Series Capacitors

High reliability DC link capacitors for power inverter applications which require superior life expectancy under harsh operating conditions of wind and photovoltaic installations.

Product Highlights

- Segmented, self-healing metallized polypropylene for long life expectancy > 100,000 hours
- High capacitance density and ripple current capabilities for replacement of electrolytic capacitors
- Low ESR and ESL
- Compact and cost effective design
- Tested to the environmental specifications of MIL-STD-202

Specifications

- Capacitance Range: 160 μ F to 680 μ F standard (others available upon request)
- Capacitance Tolerance: +/- 10% standard
- Rated Voltage: 900 to 1300 VDC
- Operating Temperature range: -55°C to +85°C standard (+105°C upon special request)
- Test Voltage Between Terminals: 150% rated voltage for 10 sec
- Test Voltage Between Terminals and Housing: 5kVDC for 10 sec
- Enclosure/Construction: aluminum housing, brass terminals with dry resin, UL 94V-0 encapsulant
- RoHS Compliant



55DC Link Series

Dimensions

M Configuration

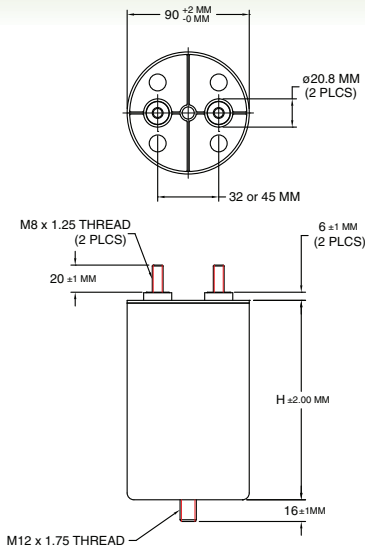

F Configuration

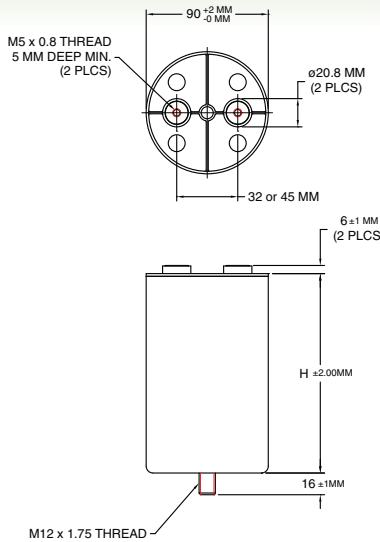

S Configuration

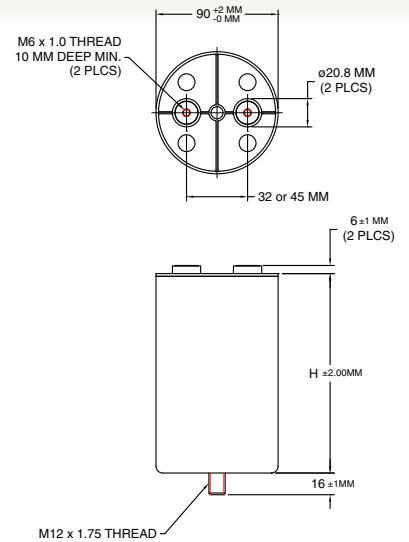

55DC Link Series Part Numbering System



Series

Voltage

Capacitance

Terminal Code

901 = 900 VDC
112 = 1100 VDC
132 = 1300 VDC

321 = 320 μ F
441 = 440 μ F

M = M8 External Thread, 45mm center-center
F = M5 Internal Thread, 45 mm center-center
S = M6 Internal Thread, 45 mm center-center

MA = M8 External Thread, 32mm center-center
FA = M5 Internal Thread, 32 mm center-center
SA = M6 Internal Thread, 32 mm center-center

Part Number	Rated Voltage (VDC)	Capacitance (μ F)	D Diameter (mm)	Height H (mm)	Typ ESR (mOhms)	Typ ESL (nH)	Irms Max. (A) M	Weight (kg)
55DC-901-321-XX	900	320	90	97	2.1	50	60	0.80
55DC-901-441-XX	900	440	90	120	1.8	60	60	1.00
55DC-901-561-XX	900	560	90	145	2.1	60	60	1.10
55DC-901-681-XX	900	680	90	170	2.5	80	60	1.30
55DC-112-221-XX	1100	220	90	97	2.5	50	60	0.90
55DC-112-281-XX	1100	280	90	120	2.1	50	60	1.20
55DC-112-361-XX	1100	360	90	145	1.9	60	60	1.30
55DC-112-421-XX	1100	420	90	170	2.3	80	60	1.30
55DC-132-161-XX	1300	160	90	97	2.1	50	60	0.80
55DC-132-211-XX	1300	210	90	120	1.9	50	60	1.00
55DC-132-251-XX	1300	250	90	145	2.5	60	50	1.20
55DC-132-321-XX	1300	320	90	170	2.8	80	53	1.30



Spectrum Advanced Specialty Products

8061 Avonia Road • Fairview, Pennsylvania 16415
Phone: 814-474-1571 • Fax: 814-474-3110

www.SpecEMC.com